



Extreme Performance from Rexnord

RexHiPro



RexHiPro
good corrosion resistance
excellent loading capacity



**Corrosion resistant
& highly loadable**

through anti-corrosion
coating on all chain parts

RexHiPro

Extreme Performance from Rexnord.

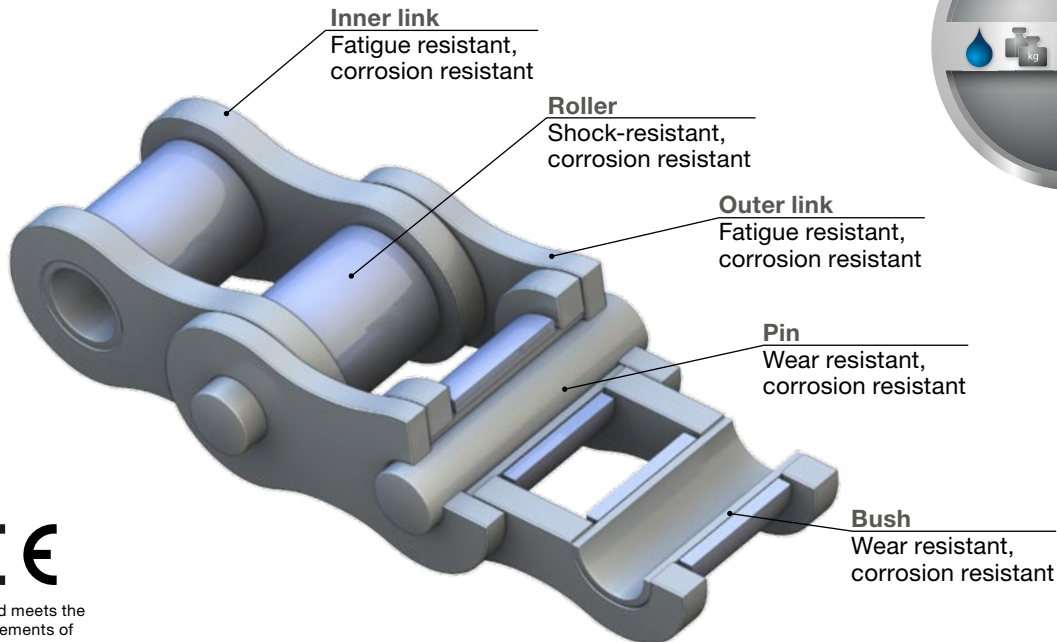

Rexnord meets the
requirements of
Machine Directive
2006/42/EC

APPLICATION

- Wet and outdoor usage
- Food, beverage, and packaging industries
- Amusement parks
- Agriculture and forestry machinery

CHARACTERISTICS

- Anti-corrosion coating for all chain parts
- Corrosion resistance over 600 hours (salt spray test conforms to DIN 50021)
- Breaking strength and long-term loading capacity comparable with RexPlus stainless chain
- All measurements according to DIN, ANSI and ISO-Norm
- No process-related hydrogen embrittlement
- NSF H2 certification, RoHS:2005 compliant for electronics industry
- Free from chromium VI: conforms to guidelines 2011/65/EG, ROHS and Directive 2000/53/EC

ADVANTAGES

- Good corrosion resistance
- Resistant to liquids from the automotive industry under VDA 621-412
- Visually attractive chain
- Long working life
- Improved cost-effectiveness

LUBRICATION

- Operating temperature: -30° C to +130° C
- With high temperature lubricants use is possible up to 250° C
- Use of RexPro lubrication, free from heavy metals: silicon and Teflon

RexHiPro - European Standard

Extreme Performance from Rexnord.

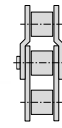

Simplex roller chains



Applications & Characteristics

- Outstanding corrosion resistance
- Food and beverage industry
- High loading capacity



Maintenance & Service life

- Servicing intervals as for RexPro
- Long service life



Eco-friendly

- NSF H2 certification
- RoHS:2005 compliant
- Free from chromium VI



Rexnord meets the requirements of Machine Directive 2006/42/EC

RexHiPro-Simplex roller chains, DIN ISO 606 (DIN 8187)

Chain No.	Pitch		Width between inner plates		Roller diameter	Pin diameter	Width over inner link	Plate depth	Transverse pitch	Pin length	Connecting pin length	Bearing area	Required minimum tensile strength DIN/ISO	Average tensile strength	Weight	Loose parts					
	inch	mm	b ₁ min	d ₁ max	d ₂ max	b ₂ max	g max	e	a ₁ max	a ₃ max	A	F _U	F _B	q	A	B	C	E	L	S	
			mm	mm	mm	mm	mm	mm	mm	mm	mm	mm	cm ²	N	N	kg/m					
08 B - 1 HiPro	0.50	12.7	7.75	8.51	4.45	11.30	11.6	-	17.0	20.9	0.50	17 800	21 000	0.7	x	x	x	x	x		
10 B - 1 HiPro	0.625	15.875	9.65	10.16	5.08	13.28	14.6	-	19.6	23.7	0.67	22 200	25 000	0.9	x	x	x	x	x		
12 B - 1 HiPro	0.75	19.05	11.68	12.07	5.72	15.62	15.9	-	22.7	27.3	0.89	28 900	32 000	1.2	x	x	x	x	x		
16 B - 1 HiPro	1.00	25.40	17.02	15.88	8.28	25.40	20.5	-	36.1	42.4	2.10	60 000	80 000	2.6	x	x	x	x	x		
20 B - 1 HiPro	1.25	31.75	19.56	19.05	10.19	29.00	25.7	-	40.4	47.6	2.96	95 000	120 000	3.7	x	x			x	x	
24 B - 1 HiPro	1.50	38.10	25.40	25.40	14.63	37.90	33.0	-	53.8	60.6	5.54	160 000	211 000	6.9	x	x			x	x	
28 B - 1 HiPro	1.75	44.45	30.99	27.94	15.80	46.50	37.0	-	63.3	72.8	7.39	200 000	250 000	8.6	x	x			x	x	
32 B - 1 HiPro	2.00	50.80	30.99	29.21	17.81	45.50	41.2	-	65.1	73.6	8.10	250 000	315 000	9.5	x	x			x	x	

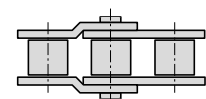
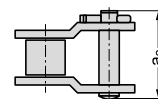
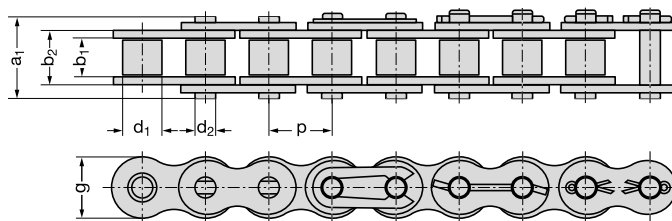

B inner link
A outer link
E connecting link with spring
S connecting link with cotter pin

L cranked link with cotter pin

C double cranked link

RexHiPro - European Standard

Extreme Performance from Rexnord.

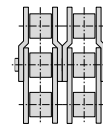

Duplex roller chains



Rexnord meets the requirements of Machine Directive 2006/42/EC



Applications & Characteristics

- Outstanding corrosion resistance
- Food and beverage industry
- High loading capacity



Maintenance & Service life

- Servicing intervals as for RexPro
- Long service life



Eco-friendly

- NSF H2 certification
- RoHS:2005 compliant
- Free from chromium VI

RexHiPro-Duplex roller chains, DIN ISO 606 (DIN 8187)

Chain No.	Pitch		Width between inner plates		Roller diameter	Pin diameter	Width over inner link	Plate depth	Transverse pitch	Pin length	Connecting pin length	Bearing area	Required minimum tensile strength DIN/ISO	Average tensile strength	Weight	Loose parts					
	p	inch	mm	b ₁ min	d ₁ max	d ₂ max	b ₂ max	g max	e	a ₁ max	a ₃ max	A	F _U	F _B	q	A	B	C	E	L	S
																mm	N	N	kg/m	x	x
08 B - 2 HiPro	0.50	12.7	7.75	8.51	4.45	11.30	11.6	13.92	30.6	33.0	1.01	31 100	43 000	1.4	x	x	(x)	x	(x)		
10 B - 2 HiPro	0.625	15.875	9.65	10.16	5.08	13.28	14.6	16.59	35.5	38.6	1.34	44 500	50 000	1.8	x	x	(x)	x	(x)		
12 B - 2 HiPro	0.75	19.05	11.68	12.07	5.72	15.62	15.9	19.46	41.7	44.4	1.79	57 800	64 000	2.3	x	x	(x)	x	(x)		
16 B - 2 HiPro	1.00	25.4	17.02	15.88	8.28	25.40	20.5	31.88	67.4	74.0	4.21	106 000	140 000	5.3	x	x	x	x			
20 B - 2 HiPro	1.25	31.75	19.56	19.05	10.19	29.00	25.7	36.45	76.9	83.6	5.91	170 000	210 000	7.3	x	x			x	x	
24 B - 2 HiPro	1.50	38.1	25.40	25.40	14.63	37.90	33.0	48.36	102.2	112.7	11.09	280 000	370 000	13.8	x	x			x	x	
28 B - 2 HiPro	1.75	44.45	30.99	27.94	15.90	46.50	37.0	59.56	122.8	132.7	14.79	360 000	500 000	17.3	x	x			x	x	
32 B - 2 HiPro	2.00	50.8	30.99	29.21	17.81	45.50	41.2	58.55	123.6	132.4	16.21	450 000	530 000	18.8	x	x			x	x	

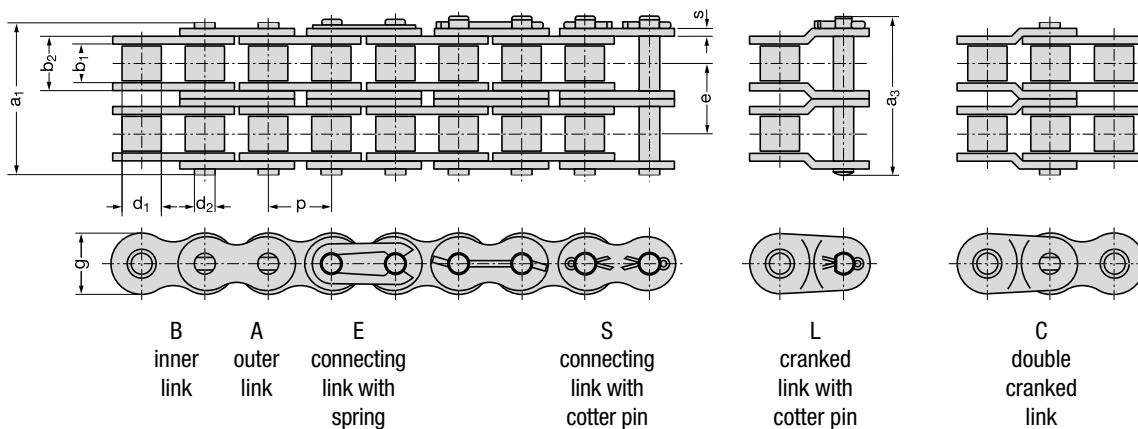

RexHiPro - American Standard

Extreme Performance from Rexnord.

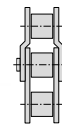

Simplex roller chains



Applications & Characteristics

- Outstanding corrosion resistance
- Food and beverage industry
- High loading capacity



Maintenance & Service life

- Servicing intervals as for RexPro
- Long service life



Eco-friendly

- NSF H2 certification
- RoHS:2005 compliant
- Free from chromium VI



Rexnord meets the requirements of Machine Directive 2006/42/EC

RexHiPro-Simplex roller chains, DIN ISO 606 (DIN 8188)

Chain No.	Pitch		Width between inner plates		Roller diameter	Pin diameter	Width over inner link	Plate depth	Transverse pitch	Pin length	Connecting pin length	Bearing area	Required minimum tensile strength DIN/ISO	Average tensile strength	Weight	Loose parts					
	inch	mm	b ₁ min	d ₁ max	d ₂ max	b ₂ max	g max	e	a ₁ max	a ₃ max	A	F _U	F _B	q	A	B	C	E	L	S	
			mm	mm	mm	mm	mm	mm	mm	mm	mm	cm ²	N	N	kg/m						
40 - 1 HiPro	0.50	12.7	7.85	7.95	3.96	11.15	11.6	-	16.3	19.1	0.44	13 900	20 000	0.7	x	x	(x)	x	(x)		
50 - 1 HiPro	0.625	15.875	9.40	10.16	5.08	13.80	14.6	-	20.3	23.0	0.70	21 800	30 000	1.1	x	x	(x)	x	(x)		
60 - 1 HiPro	0.75	19.05	12.57	11.91	5.94	17.70	17.7	-	25.7	28.6	1.05	31 300	40 000	1.5	x	x	(x)	x	(x)		
80 - 1 HiPro	1.00	25.4	15.75	15.88	7.92	22.50	23.5	-	33.0	38.0	1.78	55 600	65 000	2.6	x	x	x	x	x		
100 - 1 HiPro	1.25	31.75	18.90	19.05	9.53	27.40	29.2	-	39.4	44.9	2.61	87 000	105 000	3.8	x	x			x	x	
120 - 1 HiPro	1.50	38.1	25.22	22.23	11.10	35.30	34.4	-	49.8	56.1	3.92	125 000	145 000	5.5	x	x			x	x	
140 - 1 HiPro	1.75	44.45	25.22	25.40	12.70	37.00	40.8	-	53.4	59.3	4.70	170 000	220 000	7.2	x	x			x	x	
160 - 1 HiPro	2.00	50.8	31.55	28.58	14.27	45.00	47.8	-	63.6	68.9	6.42	223 000	260 000	10.3	x	x			x	x	

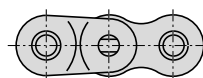
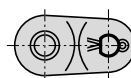
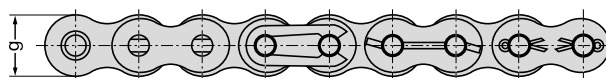
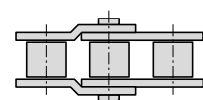
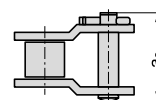
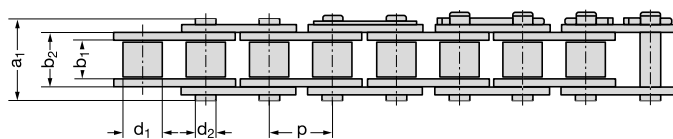

B inner link
A outer link
E connecting link with spring
S connecting link with cotter pin

L cranked link with cotter pin

C double cranked link

RexHiPro - American Standard

Extreme Performance from Rexnord.

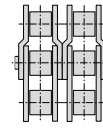

Duplex roller chains



Rexnord meets the requirements of Machine Directive 2006/42/EC



Applications & Characteristics

- Outstanding corrosion resistance
- Food and beverage industry
- High loading capacity



Maintenance & Service life

- Servicing intervals as for RexPro
- Long service life



Eco-friendly

- NSF H2 certification
- RoHS:2005 compliant
- Free from chromium VI

RexHiPro-Duplex roller chains, DIN ISO 606 (DIN 8188)

Chain No.	Pitch		Width between inner plates		Roller diameter	Pin diameter	Width over inner link	Plate depth	Transverse pitch	Pin length	Connecting pin length	Bearing area	Required minimum tensile strength DIN/ISO	Average tensile strength	Weight	Loose parts					
	inch	mm	b ₁ min	d ₁ max	d ₂ max	b ₂ max	g max	e	a ₁ max	a ₃ max	A	F _U	F _B	q	A	B	C	E	L	S	
			mm	mm	mm	mm	mm	mm	mm	mm	mm	cm ²	N	N	kg/m						
40 - 2 HiPro	0.50	12.7	7.85	7.95	3.96	11.15	11.6	14.36	30.7	33.5	0.88	27 800	40 000	1.3	x	x	(x)	x	(x)		
50 - 2 HiPro	0.625	15.875	9.40	10.16	5.08	13.80	14.6	18.11	38.5	41.3	1.40	43 600	60 000	2.0	x	x	(x)	x	(x)		
60 - 2 HiPro	0.75	19.05	12.57	11.91	5.94	17.70	17.7	22.78	48.5	51.5	2.10	62 600	80 000	3.0	x	x	(x)	x	(x)		
80 - 2 HiPro	1.00	25.4	15.75	15.88	7.92	22.50	23.5	29.29	62.4	57.1	3.56	111 200	150 000	5.2	x	x	x	x	x		
100 - 2 HiPro	1.25	31.75	18.90	19.05	9.53	27.40	29.2	35.76	75.3	87.8	5.22	174 000	220 000	7.6	x	x			x	x	
120 - 2 HiPro	1.50	38.1	25.22	22.23	11.10	35.30	34.4	45.44	95.3	101.6	7.84	250 000	290 000	10.8	x	x			x	x	
140 - 2 HiPro	1.75	44.45	25.22	25.40	12.70	37.00	40.8	48.87	103.3	109.6	9.40	340 000	440 000	14.2	x	x			x		
160 - 2 HiPro	2.00	50.8	31.55	28.58	14.27	45.00	47.8	58.55	122.1	130.1	12.84	446 000	490 000	19.5	x	x			x		

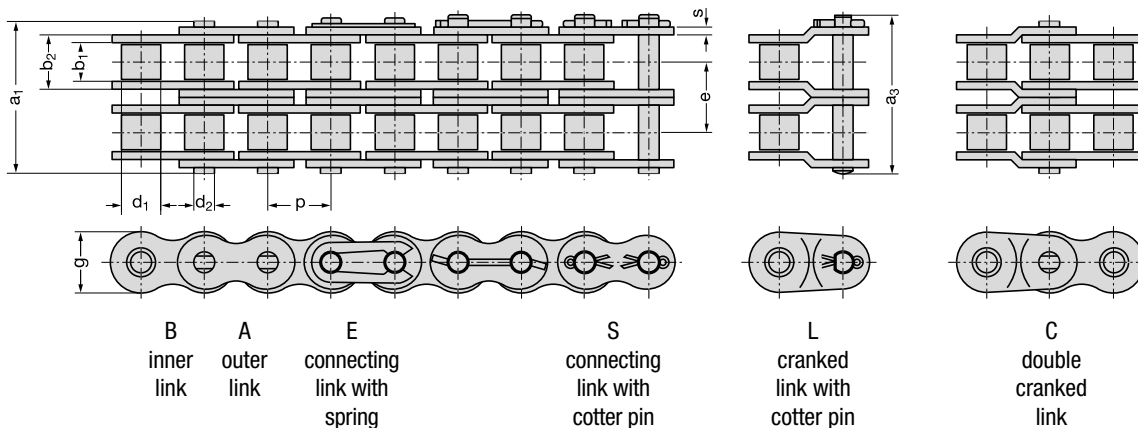

Connecting dimensions for roller chains, European and American types

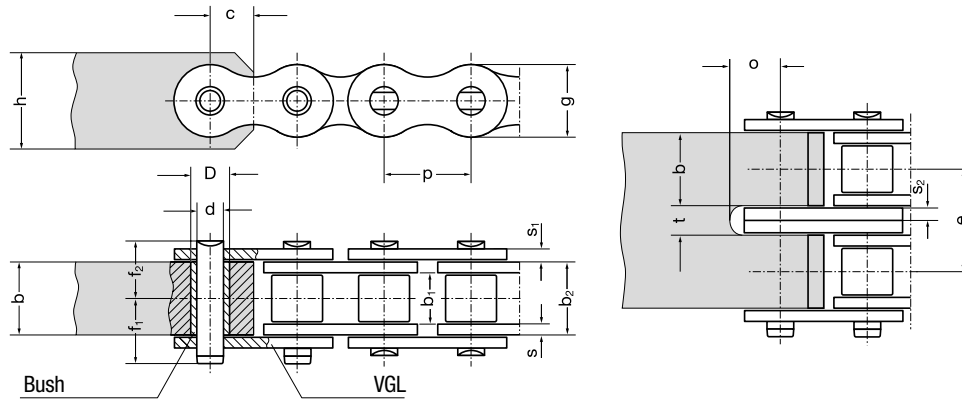

- Required material hardness of fixing elements: at least 490 N/mm²
- To increase wear resistance, fit a bush (surface hardness rating approx. 60 HRC) to the connecting element, if joint mobility is required at the connection point.
- Hardened bushes are not required in case of static loading
- Please order bushes using the corresponding bush part no.
- The bush bore diameters dC10 result from press-fitting in bore diameter DS7
- If no bushes are fitted, the bore dC10 is inserted directly into the connection element

Connecting dimensions for roller chains, European type, DIN ISO 606 (DIN 8187)

Chain no.	Pitch		Width between inner plates		Width over inner link		Plate thickness										Bore Ø					Bush part no.
	p		b ₁ min	b ₂ max	s	s ₁	s ₂	g max	e	f ₁	f ₂	h	b max	c	d C10	D S7	t	o				
	inch	mm	mm	mm	mm	mm	mm	mm	mm	mm	mm	mm	mm	mm	mm	mm	mm	mm	mm			
08 B	0.50	12.70	7.75	11.30	1.70	1.70	1.25	11.60	13.92	10.30	8.40	11	11.20	6.0	4.45	6.27	2.7	7.5	001544			
10 B	0.625	15.875	9.65	13.28	1.70	1.50	1.50	14.60	16.59	11.30	9.40	13	13.20	7.5	5.08	7.00	3.2	8.0	001543			
12 B	0.75	19.05	11.68	15.62	1.80	1.80	1.80	15.90	19.46	13.20	11.10	16	15.60	10.0	5.72	8.40	3.8	9.5	001542			
16 B	1.00	25.40	17.02	25.40	3.75	3.05	3.05	20.50	31.88	21.60	17.70	20	25.40	14.0	8.28	11.70	6.4	13.0	001541			
20 B	1.25	31.75	19.56	29.00	4.50	4.50	3.50	25.70	36.45	24.10	20.20	26	29.00	16.5	10.19	14.00	7.4	16.5	001449			
24 B	1.50	38.10	25.40	37.90	5.80	5.00	5.00	33.00	48.36	31.60	26.90	33	37.90	19.5	14.63	18.99	10.6	20.0	001540			
28 B	1.75	44.45	30.99	46.50	6.50	5.50	6.00	37.00	59.56	36.60	31.60	36	46.50	23.0	15.90	21.64	12.6	24.0	001539			
32 B	2.00	50.80	30.99	45.50	6.30	6.30	6.30	41.20	58.55	38.40	32.50	42	45.50	27.0	17.81	23.12	13.2	27.0	001538			
40 B	2.50	63.50	38.10	55.70	8.50	8.00	8.00	51.50	72.29	47.50	39.40	52	55.70	35.0	22.89	29.18	16.6	35.0	017776			
48 B	3.00	76.20	45.72	70.50	12.00	10.00	10.00	63.50	91.21	56.00	49.20	64	70.50	40.0	29.24	37.90	20.6	40.0	001535			
56 B	3.50	88.90	53.34	81.30	13.60	12.00	12.00	77.00	106.60	64.80	57.80	77	81.30	45.0	34.32	43.50	25.0	51.0	001536			

Connecting dimensions for roller chains, American type, DIN ISO 606 (DIN 8188)

Chain no.	Pitch		Width between inner plates		Width over inner link		Plate thickness										Bore Ø					Bush part no.
	p		b ₁ min	b ₂ max	s	s ₁	g max	e	f ₁	f ₂	h	b max	c	d C10	D S7	t	o					
	inch	mm	mm	mm	mm	mm	mm	mm	mm	mm	mm	mm	mm	mm	mm	mm	mm	mm				
40	0.50	12.70	7.85	11.15	1.50	1.50	11.60	14.38	11.2	8.1	11	11.10	6.0	3.96	5.98	3.2	7.0	001544				
50	0.625	15.875	9.40	13.80	2.00	2.00	14.60	18.11	12.0	10.2	13	13.80	7.7	5.08	7.65	4.2	9.0	001543				
50	0.75	19.05	12.57	17.70	2.40	2.40	17.60	22.78	14.4	12.8	16	17.60	9.0	5.94	9.00	5.0	10.0	001542				
80	1.00	25.40	18.75	22.50	3.05	3.05	23.50	29.29	20.4	16.5	22	22.30	12.0	7.92	11.67	6.8	14.0	001541				
100	1.25	31.75	18.98	27.40	4.00	4.00	28.70	35.76	23.7	19.7	26	27.40	15.5	9.53	13.82	8.4	17.5	001449				
120	1.50	38.10	25.22	35.30	4.70	4.70	34.40	45.44	30.0	24.9	30	35.20	18.5	11.10	16.13	9.8	20.0	001540				
140	1.75	44.45	25.22	37.00	5.50	5.50	40.80	48.87	31.6	26.7	36	37.00	21.5	12.70	18.29	11.6	23.5	001539				
160	2.00	50.80	31.55	45.00	6.30	6.30	47.80	58.55	36.4	31.8	42	44.70	24.0	14.27	20.70	13.2	27.5	001538				
180	2.25	57.15	35.72	50.50	7.00	7.00	54.00	65.35	41.4	35.7	47	50.60	27.0	17.46	25.35	14.6	32.0	017776				
200	2.50	63.50	37.85	54.70	8.00	8.00	60.00	71.55	45.0	39.0	52	54.60	30.0	19.84	28.38	16.6	34.5	001535				
240	3.00	76.20	47.35	67.50	9.50	9.50	70.00	87.33	55.5	47.4	62	67.50	37.0	23.80	34.28	19.6	41.0	001536				

Extreme Performance from Rexnord

Expert chains with innovative technology and materials:

- Stainless steel
- Seamless rollers
- High-tech carbon sliding sleeves
- Food-grade lubricants
- Alloy surfaces
- Anti-friction coatings



	RexAthletic	RexCarbon	RexPlus	RexPlusCarbon	RexHiPro	RexProX
--	-------------	-----------	---------	---------------	----------	---------

Chain characteristics

	RexAthletic	RexCarbon	RexPlus	RexPlusCarbon	RexHiPro	RexProX
Chain size	0,5" to 2"	0,5" to 1"	0,5" to 1"	0,5" to 1"	0,5" to 2"	0,5" to 2"
Maintenance level	low	zero	normal	zero	normal	low
Fatigue resistance	100%	100%	60%	60%	100%	100%
Tensile strength	100%	100%	60%	60%	100%	100%
Specific bearing load	100%	50%	50%	50%	100%	100%
Chain speed	up to 20 m/s	up to 20 m/s	up to 4 m/s	up to 2 m/s	up to 20 m/s	up to 20 m/s
Rust and acid resistant	no	no	damp	damp	partly	no

Environmental conditions

	RexAthletic	RexCarbon	RexPlus	RexPlusCarbon	RexHiPro	RexProX
Temperature range	0° C to 120° C *	-40° C to 100° C *	-40° C to 120° C *	-40° C to 100° C *	-30° C to 130° C *	0° C to 120° C *
Damp, corrosive atmosphere	partly	partly	damp	damp	damp	partly
Dusty	partly	damp	damp	damp	partly	partly
Hygienic	NSF H2	NSF H1	NSF H1	NSF H1	NSF H2	NSF H2

An appropriate lubrication method should be selected, depending on chain speed.

These guideline values are valid for shock-free loading, a shaft centre distance of 40 x pitch, with the chain running over two sprockets and a number of teeth z1 = 21; z2 = 42. Other drive parameters can be determined using the Rexnord chain calculation program Rex®Drive.

*The temperature range can be extended by using special high- or low-temperature lubricants.



Overview Rexnord Chains

Roller Chains

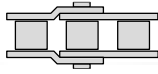

REXNORD

RexPro
RexPro lubrication
improved wear resistance
high fatigue resistance

- Outstanding protection against corrosion and wear
- Unique protection against chain joint stiffness
- Extremely eco-friendly

REXNORD

RexAthletic
good loading capacity
extended lubrication intervals

- Durable and low-maintenance
- Longer servicing intervals
- High loading capacity

REXNORD

RexCarbon
no lubrication
low noise

- Maintenance-free
- Low noise
- Eco-friendly

REXNORD

RexPlus
excellent corrosion resistance
high reliability

- Excellent resistance to rust and acids
- Highly reliable
- Fulfills hygiene requirements
- NSF H1 certification

REXNORD

RexPlusCarbon
no lubrication
excellent corrosion resistance

- Combination of RexPlus and RexCarbon
- Excellent resistance to rust and acids
- Maintenance-free
- NSF H1 certification

REXNORD

RexHiPro
good corrosion resistance
excellent loading capacity

- Outstanding corrosion resistance
- Long service life
- High loading capacity

Link-Belt
a brand of REXNORD

- The optimum choice for light and medium duty
- Good cost-benefit ratio
- High availability

REXNORD

RexProX
RexPro lubrication
improved wear resistance
high fatigue resistance

- Extremely high loading capacity
- Long service life
- Outstanding protection against corrosion and wear

Leaf Chains

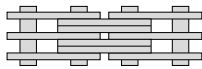

REXNORD

RexPro
RexPro lubrication
improved wear resistance
high fatigue resistance

- Outstanding protection against corrosion and wear
- Unique protection against chain joint stiffness
- Extremely eco-friendly

REXNORD

RexHiPro
good corrosion resistance
excellent loading capacity

- Outstanding corrosion resistance
- Long service life
- High loading capacity

REXNORD

RexAthletic
good loading capacity
extended lubrication intervals

- Durable and low-maintenance
- Longer servicing intervals
- High loading capacity
- Extreme wear resistance for double-length service life

REXDL
a brand of REXNORD

- The optimum choice for light and medium duty
- Good cost-benefit ratio
- Good availability